

Product sheet part 1

Bleacher modules SitUp

Bleacher module SitUp ST

W/H/D: 75/89/139 cm

Weight: 24,2 kg

Side view

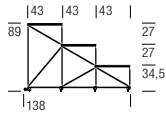

Front view



Top view

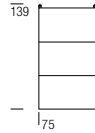

Bleacher module SitUp CE 45°

W/H/D: 144/89/143 cm

Weight: 39,3 kg

Side view

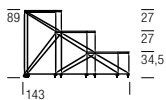

Front view

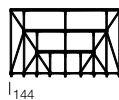

Top view

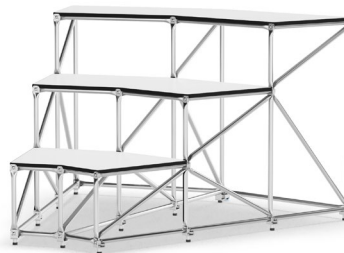
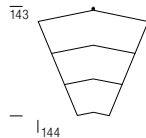

Bleacher module SitUp CX 45°

W/H/D: 144/89/140 cm

Weight: 39,8 kg

Side view

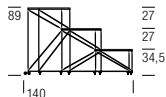

Front view

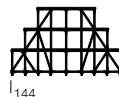

Top view

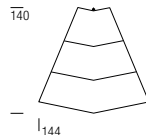

Product sheet part 2

Bleacher modules SitUp

Description

With their stainless steel tube structure and the three steps, the SitUp modules are versatile, light and stable at the same time. The combination of linear (SitUp ST) and angled modules (SitUp CE 45° and CX 45°) allows a variety of different formations to be arranged in a row. In the ST version in particular, the SitUps can be stacked lengthwise to create storage space lengthwise to save storage space.

Features

All SitUp models are based on a three-tiered stainless steel tube structure. Up to three people can be seated per module. The SitUp models have one to two casters on the back to allow repositioning by one person. System 180 common accessories are possible for the SitUp family. Each SitUp unit is supplied with two Velcro straps, added after assembly, to ensure tool-free connection to adjoining SitUp modules and to prevent slippage. In communication, the furniture is referred to as a stand module, but in terms of static and usage requirements, it is similar to a seat module technical requirements for safety. All SitUp models are available in common uni decors. For the tubular structure, a choice can be made between the brushed SteelLine or powder-coated BlackLine varitane. The adjustment unit in the feet is used exclusively to compensate for uneven floors. This is not a height adjustment.

Available space

Based on an average seat width of approx. 400 mm (see DIN 33402), 5 adults could be seated on each module, 2 + 2 + 1. Due to the space required to put down the feet, we recommend a maximum of three people sitting offset.

Packaging

For transportation, all furniture is packed with appropriate packing material.

Assembly

The furniture is assembled on site by trained assemblers. The assembly manual exists as an assembly aid for the personnel.

Service life

The product is durable when used properly.

Influence on other products

- not applicable -

Design

The design of the SitUps is simple, constructive and based on the classic System 180 design (tubular construction with MDF floors). Compared to fixed and voluminous grandstand construction, the SitUp convince with the lightweight construction and the mobile, compact unit. The resulting use is self-explanatory and therefore intuitive.

Warnings

The dimensioning of the SitUps, as mobile grandstand modules, cannot be changed for safety reasons.

The static load limit holds up to 5 persons of 80 kg each.

At maximum load, the feet can leave imprints in hard floors (wood, linoleum, etc.).

The fixing of the floors is not intended for permanent removal and installation.

Product sheet part 3

Bleacher modules SitUp

Operating instructions

The assembly information of all SitUp models can be found in the assembly manual from point 3.10 Stand module SitUp.

Care Instructions

Melamine-coated surfaces

Melamine-coated tabletops can be wiped with a soft, dry, lint-free cloth during regular cleaning. Never let moisture accumulations soak into furniture edges and corners! Never allow moisture (from glass rims, plant pots, etc.) soak into the surface or edges of the furniture. Water-soluble soiling can be wiped away using a well-wrung out damp cloth. You can add a small amount of a mild cleaning agent to the water. Never use caustic or scouring cleaning agents! Wipe dry after cleaning.

Stainless steel parts

Stainless steel surfaces should be cleaned using cleansing cloths, soft sponges or brushes with clean, hot water, with all-purpose cleaner containing no abrasive ingredients where necessary. Before drying, all traces of detergent should be carefully removed.

Particular types of staining (e.g. limescale residues) may be removed with light acidic cleaning agents containing 10 % citric or acetic acid. Wipe all treated surfaces thoroughly to remove all residues .

Please note: The corrosion resistance of stainless steel may be reduced by acids and halogen compounds (chlorides, bromides, iodides). For this reason, no cleaning agents containing strongly acidic salts should be used. Such substances include decalcifiers based on formic acid and amidosulfuric acid, drain cleaning agents, hydrochloric acid and silver cleaning agents. Do not use any chloride solutions, caustic or abrasive substances (scouring powder, steel wool), nor polishes, wax or bleaching agents.

To avoid extraneous rust, do not use either cleaning utensils made of non-stainless steel (spatulas, steel wool) or other items previously used to clean non-stainless steel.

Disposal

The furniture can be completely dismantled at the end of its useful life. The components can be separated according to their recyclable material classes and their waste code number (AVV) for further recycling.

Frame, castors and small parts: 20 01 40 AVV (metals).

MdF floors: 03 01 05 AVV (sawdust, shavings, offcuts, wood, chipboard and veneer other than those mentioned in 03 01 04).

Stainless steel: 20 01 040 AVV (metals and waste containing metals, scrap and metal waste, scrap metal, used metals) or powdered steel and stainless steel: 17 04 04 AVV (mixed metals).

The furniture can also be disposed of completely assembled: 20 03 07 AVV (bulky waste).

Technical data sheet

Bleacher modules SitUp

Component	Description	Value/Material	Norm
StyleBoard MDF black	Attractive MDF panels with uniform structure coloured right through in black		EN 622-5:1997 EN 622-3:2004
	Gross density	770-780 kg/m ³	DIN EN 622-5
	Longitudinal bending tensile strength	8–28 N/mm ²	EN 310
	Bending tensile strength across width	0,1–0,4 N/mm ²	EN 319
	Swelling over 24 hrs	7–20 %	EN 314
	Bending elastic modulus	1600–2900 N/mm ²	EN 310
	Fire performance	Normal flammability Ds2, d0	
	Formaldehyde emission class	E1	DIN EN 717-2 DIN EN 120
	Harmless in contact with foodstuffs		EN 1186 EN 13130 CEN/TS 14234
	Surface texture VV – Gloss level	≤ 20 gloss units	DIN EN 527
Steel tubing	Ferritic corrosion-resistant stainless steel tubing 1.4509, brushed surface	Ø 20x1 mm	DIN EN 10217-7
	Strength / Eddy current tested	6000 mm, -0/+20 mm	EN 10204
	Tolerance	D4/T3	EN 1127

The bleacher modules SitUp conform to the norms on strength, durability and safety contained in the DIN EN 14073-2 2004-11 standard.